

THESE ARE COORDINATION DRAWINGS ONLY TO PROGRESS WORKS AND ARE NOT DESIGN DRAWINGS. ALL DIMENSIONS TO BE CHECKED ON SITE.

GENERAL NOTES:
 1. THIS DRAWING SHALL BE READ IN CONJUNCTION WITH ALL RELEVANT ARCHITECTURAL, STRUCTURAL, CIVIL, MECHANICAL & ELECTRICAL DRAWINGS AND ALL RELEVANT SECTIONS OF THE MECHANICAL & ELECTRICAL SPECIFICATIONS.
 2. DO NOT SCALE FROM THIS DRAWING.
 3. ALL DIMENSIONS ARE IN MILLIMETERS UNLESS OTHERWISE STATED. ALL DIMENSIONS TO BE VERIFIED ON SITE AND APPROVED BY THE ENGINEER.



Amenity Terraces
 Results – Horizontal Illuminance (lux)
 Eav= 12.83
 Emin= 2.38
 Emax= 54.66
 Emin/Emax= 0.04
 Emin/Eav= 0.19
 Emax/Eav= 4.26

1 EXTERNAL LIGHTING LAYOUT -- FIRST FLOOR
 1:201 @A1

- Key
- Luminaire A VIA ASY 360mA CLO 3000K LED; Lamp 42; MF-0.92
 - Luminaire B VIA SYM 630mA CLO 3000K LED; Lamp 42; MF-0.92
 - Luminaire C ASE12 LED 18W CLO GR2 3000K EXP ;Lamp 42; MF-0.92
 - Luminaire D RL19069 Lamp 8W LED;MF-0.92

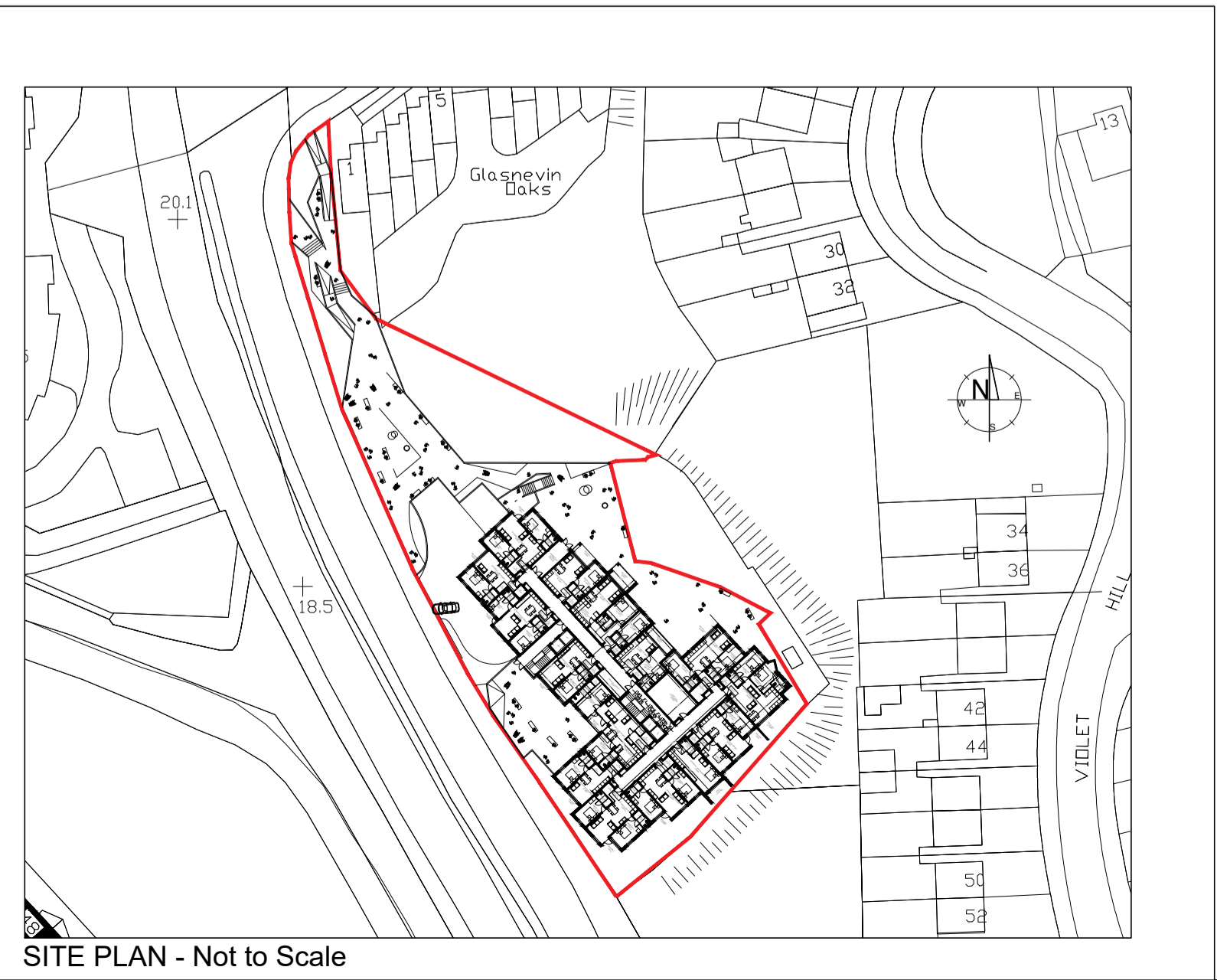

SITE PLAN - Not to Scale

REV.	DATE	DESCRIPTION	DRN	CHK.
A	25.03.22	Issued to support planning submittal	FD	PC

CARMODY ENGINEERING
 Workspace Drogheda,
 Co. Louth A92 K650
 Tel: +353 86 172 5291
 Email: info@carmodyengineering.ie

Project:
 The Development of the Site of the former Royal Oak Public House, Finglas Road & Old Finglas Road, Glasnevin, Dublin 11

Title:
 MEP LAYOUT DRAWINGS
 EXTERNAL LIGHTING LAYOUT
 FIRST FLOOR

Scale: as indicated	Drawn By: F.D.	Project No.: 2144	Drawing No.: E201	Revision: A
Date: 22/06/2021	Checked By: P.C.			